



OAK CUSTOM

***Oak Offers This New Series A Powerful Sound,
Excellent Attack And Impressive Looks***



Following in the footsteps of our Birch, Maple and Beech drum series, Oak shows great promise as a drum shell material. A solid fundamental delivers a powerful sound while its character allows for a unique shell size lineup. Beautifully grained this hardwood creates a drum with stunning looks.



OAK

Newly Designed, All Oak Shells

Utilization of Yamaha's Air-Seal System allows for the first time use of oak in a drum shell. As in our Maple and Birch series, this process delivers a shell that's perfectly round, with uniform thickness and excellent durability. The bass drum shell uses a 7-ply design while tom tom and floor tom shells are 6-ply. All shells throughout the entire range deliver a solid fundamental and powerful sound.

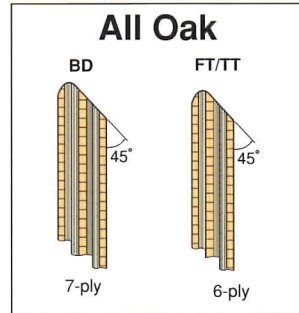

17-Inch Bass Drums

Bass drums in the Oak Series are available in 24-, 22-, 20-, and 18-inch sizes all being 17-inches deep which is deeper than most standard bass drums. The added depth enhances the oak's tone with greater bottom end and more power.



Unique Size Floor Tom

Due to the unique characteristics that this new material provides, we rethought the design of the lineup's tom toms. The result was the addition of a 14-inch deep tom to the common 16-, 15-, and 13-inch floor toms. The new size offers a unique sound that is versatile enough for use as either a main or sub floor tom.

7 Color Finishes

The Oak Series is available in three glossy and four matte colors. Each a high-quality finish that shows the natural beauty of the wood's grain.

COLOR FINISHES [Glossy Finishes]



AMO : York Honey Amber Oak



BLO : Blue Ridge Blue Oak



BRO : Bryce Canyon Brown Oak

[Matte Finishes]



MRO : Matte Sedona Red Oak



MBN : Matte Badlands Brown Oak



MBK : Matte Ozark Black Oak



MNO : Matte Natural Oak

SHELLS
NY2F4 (ADDITIONAL)
NBD822U NTT808J
NTT812U NTT810U
NTT813U NTT814
NFT816 NFT818
TH945A NFT813U
NSD087

HARDWARE
CS845x2
HS740
SS840
DFP780
CH740
CH745x2
WS865
WS904
CL945A
P80SA
DS840



York Honey Amber Oak

*Please understand that the woods used are natural products therefore grain and color, such as light and dark areas, will differ between drums.

CUSTOM With YESS

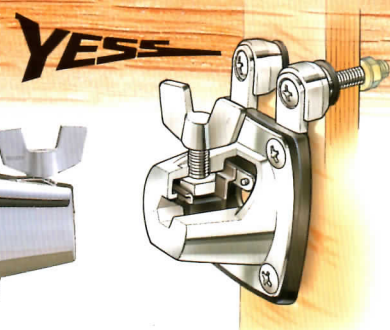

YESS

The Yamaha Enhanced Sustain System (YESS) provides minimum mount to shell contact to increase the drum's resonance while providing maximum dynamic range and sustain. YESS mounts are attached to the shell at the point where the vibration of the shell is only minimally reduced. Rod clamps use a nylon bushing to tighten around the hexagonally shaped tom arm for enhanced stability. The same mounting concept is also incorporated on our floor tom brackets, providing unmatched sustain.



Ball Mount & Clamp

The large resin ball secured with an enlarged wing bolt has provided drummers with extremely flexible and stable tom placement for over twenty years. Even after setup is complete you are still free to tune bottom heads without having to remove the tom from the mount. An internal retaining plate, inserted below the wing bolt, ensures maximum stability to withstand the most rigorous performances.



New Small Lugs

These newly designed, small round shaped lugs are easily attached to the shell with a single bolt. Small footprints offer minimum lug to shell contact allowing the shell to deliver maximum tone. They also provide precise and secure tuning.

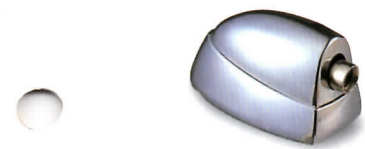
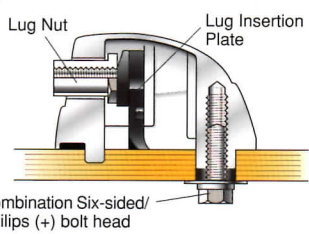

Bass Drum Spurs

A sturdy hexagonal design and fixed angle position allow our spurs to withstand and absorb the tremendous impact of repeated bass drum kicks. Height adjustment and the releasing and retracting of the pointed spur is made easily with a drum key.



Pipe Clamp

Inside the pipe clamp mounted on the bass drum, a unique nylon bushing developed by Yamaha tightens around the tom holder pipe. This innovative design eliminates slippage, and prevents unwanted buzz or damage to the pipe.

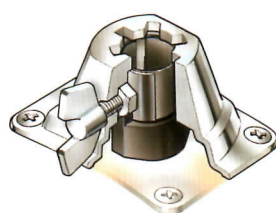

18" New Floating Bass Drum System

Height adjustment on the pedal side of the bass drum is possible with the pipe post stabilizer. Use of this system ensure that the beater makes contact at the center of the head. The stabilizer fits into a pipe clamp on the underside of the drum that allows quick and easy adjustment of the height. The post is equipped with a memory clamp that ensures subsequent settings will be quick and precise every time while a pair of supports provides added stability.



SHELLS
 NBD818UF
 NTT810U
 NTT812U
 NFT814
 NSD085

HARDWARE
HW665
 (HARDWARE KIT)
 CS655
 CS650
 HS650
 SS650
 FP700

(OPTIONAL)
 TH945A
 DS840



Blue Ridge Blue Oak Matte Natural Oak Matte Sedona Red Oak



Bryce Canyon Brown Oak Matte Badlands Brown Oak Matte Ozark Black Oak

NSD085 Size : 14 "x5 1/2"

SNARE DRUMS

Shell : All Oak 6-ply

Rim : DynaHoop (2.3mm triple flange steel) with 10 holes

Batter Snare :

Adjustable Snare Wires

Bottom Snare :

Short / Hi-carbon steel /

25 strands (7"), 20 strands (5 1/2")

Head : Batter - Remo Ambassador Coated

Bottom - Remo Ambassador Snare

Strainer : Release side - New H type

Butt side - B type

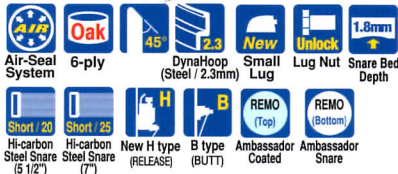

NSD087 Size : 14 "x7"



Adjustable Snare Wires

The snares under the batter head are attached to an adjustment knob to regulate snare pressure against the head. Against the bottom head is a set of hi-carbon steel snares. Both snares can be used simultaneously, separately, or switched off as you like.

Strainers

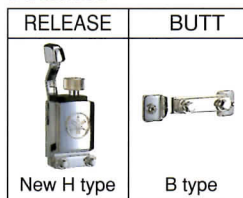

New H type

B type

SHELLS

NY2F4
NBD822U
NTT812U
NTT813U
NFT816
TH945A

(ADDITIONAL)
NSD085

HARDWARE

CS845
CS840
HS740
SS840
FP750
CH740
DS840



York Honey Amber Oak

SHELLS

NY0T4
NBD820U
NTT810U
NTT812U
NTT814
TH945A
CL945A

(ADDITIONAL)
NTT808J
NTT816
NSD085

HARDWARE

CS845x2
HS740
SS840
FP750
CH740
WS865
CSAT926
DS840



Matte Sedona Red Oak

SHELLS

NY2T4
NBD822U
NTT810U
NTT812U
NTT814
TH945A
CL945A

(ADDITIONAL)
NTT808J
NTT816
NSD085

HARDWARE

CS845x3
HS740
SS840
FP750
CH740
WS865
CSAT926
DS840



Blue Ridge Blue Oak

Components	Bass Drums				Mounted Toms						Floor Toms				
Diameter	24"	22"	20"	18"	16"	14"	13"	12"	10"	8"	18"	16"	15"	14"	13"
Size	x17" NBD824U*	x17" NBD822U*	x17" NBD820U*	x17" NBD818UF*	x14" NTT816	x12" NTT814	x10" NTT813U*	x9" NTT812U*	x8" NTT810U*	x7" NTT808J	-	x14" NFT816U*	x14" NFT815U*	-	x14" NFT813U*
Model No.															
Tuning Bolts	10	10	10	8	8	8	6	6	6	5	8	8	8	8	6
Hoops	All Oak, 18" only Floating Design				DynaHoop (2.3mm Steel)										
Head	Top	Remo Power Stroke P3 (24", 22", 20"Batter) Remo Coated Ambassador (18"Batter)				Remo Clear Ambassador									
	Bottom	Remo Ebony Power Stroke P3 (Front)				Remo Clear Ambassador									

* Those products with product numbers ending with a "U" are Universal Size Models.

*Some models may not be available in some countries.

*Colors shown in this catalog may not be represented exactly as the original colors due to printing processes involved.

*Specifications are subject to change without notice.



This document is printed on chlorine-free (ECF) paper with soy ink.



CREATING 'KANDO' TOGETHER

LDR0210 011210 Printed in Japan